



# GOT DATA? NOW WHAT?

**DRAFT PROGRAM  
10/3/18**

**Maryland Assessment Group  
2018 Annual Conference**

**November 14-15, 2018  
Clarion Resort & Conference Center  
Ocean City, Maryland**

Join us on [Twitter](#) - [@MDAssessmentGrp](#)  
Facebook - <https://www.facebook.com/mdassessmentgroup>

---

Join us on [Twitter](#) - [@MDAssessmentGrp](#)  
Facebook - <https://www.facebook.com/mdassessmentgroup>

**MARYLAND ASSESSMENT GROUP  
ANNUAL CONFERENCE**

**NOVEMBER 14-16, 2018  
CLARION RESORT & CONFERENCE CENTER  
OCEAN CITY, MARYLAND**

**MAG BOARD OF DIRECTORS**

Deborah Gilmartin  
Melissa Mulligan  
Heather Lageman

Julian Katz, Executive Director  
Deborah Gilmartin, Program Director  
Marcia Porter, Media Specialist

**The MAG Board of Directors wishes to thank the vendors and sponsors for their financial support. Their support and contributions reduce the cost of this conference for Maryland educators.**

*Conference arrangements provided by CONFERENCE SOLUTIONS*

Join us on [Twitter](#) - [@MDAssessmentGrp](#)  
Facebook - <https://www.facebook.com/mdassessmentgroup>

**PRE-CONFERENCE SESSIONS**  
**Wednesday, November 14, 2018 11:00 a.m. – 3:00 p.m.**  
Salon B, Admission Ticket Required

**11:00 a.m. – 12:30 p.m. SESSION 1**  
**12:30 p.m. – 1:30 p.m. LUNCH**  
**1:30 p.m. – 3:00 p.m. SESSION 2**

**SESSION 1**

***“Developing a Systemic Assessment Plan”***

**Presenters: Dr. Bonnie Hain, CenterPoint Education Solutions & Heather Lageman, Baltimore County**

In a world where everyone wants to increase data-driven instructional planning while simultaneously reducing testing time, it's helpful to have a systemic assessment plan--an annotated list of the district, school, and classroom-based assessments available alongside the instructional decisions that can be made based on each assessment. In this session, participants will use a structured protocol to work through both the data requisite for districts, schools, and classrooms, and means to evaluate the quality of assessments designed to provide that requisite data. District teams will have an opportunity to design, develop, and/or refine their systemic assessment plan.

**Need Pics**

**SESSION 2**

***“You’re Curriculum May Not be Aligned and You Don’t Even Know It”***

**Presenter: Carla Moore, Learning Sciences International**

Is your curriculum aligned? How do you know? These are important questions. True curriculum alignment means alignment to the essentials of standards, the instructional shifts demanded by the standards, and integrated assessments. And that is only the beginning! Join Carla Moore for a workout session to self-assess your systems and learn the critical steps to build an integrated and aligned system that raises the floor for teaching and learning. Let’s take the guess work out of providing a curriculum to support implementation for all students.

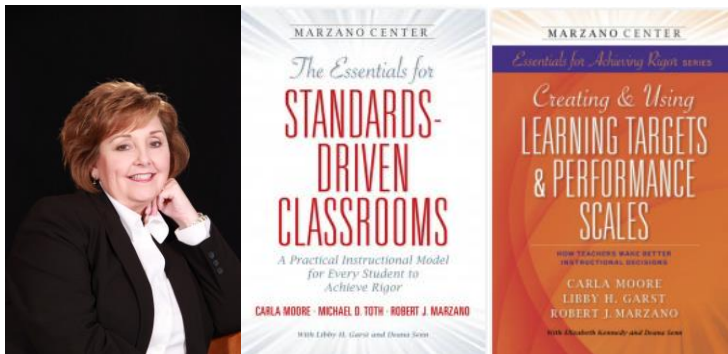

Join us on [Twitter](#) - [@MDAssessmentGrp](#)  
Facebook - <https://www.facebook.com/mdassessmentgroup>

# Setting the Baseline

## WEDNESDAY, NOVEMBER 14, 2018

9:00 a.m. – 9:00 p.m.

### **REGISTRATION**

Lower Terrace Lobby

11:00 a.m. – 3:00 p.m.

### **PRE-CONFERENCE SESSIONS**

Salon B

Ticket Required for Admission – See description, opposing page

### **VENDOR DISPLAYS IN THE VENDOR EXHIBIT HALL:**

Starting on Wednesday, November 14, 2018 at 3:30 p.m. and closing on Thursday, November 15, 2018 at 5:30 p.m.

### **AUDIENCE FOCUS CODES:**

E=Elementary School

G=General, Geared to All

M=Middle School

R=Research

H=High School

3:30 p.m. - 5:45 p.m., Salon B

### **Local Accountability Coordinators' Meeting**

Led by **TBD**, MSDE

Local Accountability Coordinators and MSDE staff will gather for a formal state meeting.

3:30 p.m. - 4:30 p.m., Conference Room 1 & 2

Audience Code: G

***“Intentional Item-Writing: The Development of Testlets to Measure Student Achievement”***

**Presenter: Dave Nelson, TalentEd & George Mason University**

Testlets – small groups of questions using a common stimulus – are powerful assessment tools that can help to measure student progress along a continuum of learning. In this session, we’ll explore some strategies for developing testlets that can help to support making instructional decisions.

3:30 p.m. - 4:30 p.m., Conference Room 3

Audience Code: G

***“An Innovative Approach to Measuring Oral Reading Fluency, Comprehension and Foundational Reading Skills”***

**Presenter: Steve Westfall, NWEA**

This session will provide participants the opportunity to learn more about MAP Reading Fluency. Learn how it provides online, adaptive assessment that measure fluency, foundational skills, and reading comprehension for all types of K-3 readers. With automatic scoring capabilities, it provides class reports that highlight student strengths and weaknesses and provides audio recordings for teachers to review and share with other educators and parents.

## WEDNESDAY, NOVEMBER 14, 2018

3:30 p.m. – 4:30 p.m., Conference Rooms 4 & 5

Audience Code: G

### ***“Root Cause Analysis with No Pain and No Blame”***

**Presenter: Ronald Thomas, Towson University**

This session will describe a five-step protocol used by teams to dig deeply into curriculum, instruction, and assessment data. The protocol enables teams to discover the component of capacity (the systems or processes that need to be tweaked) with the most leverage to make the biggest difference in student learning.

3:30 p.m. - 4:30 p.m., Conference Room 6

Audience Code: G

### ***“Need Title”***

**Presenter: Michele Hertel, Scantron**

During this session the presenter will outline various factors and metrics that should be considered when evaluating ESSA solutions. In addition, innovative approaches to utilizing formative and interim assessments to meet ESSA requirements will be discussed. We will demonstrate how formative and interim assessment results can be used to reduce testing time, connect to instructional resources, customize student learning paths, and measure student progress.

4:45 p.m. – 5:45 p.m., Conference Room 1 & 2

Audience Code: G

### ***“Developing Instructional Rubrics”***

**Presenter: Dave Nelson, George Mason University**

Formative assessment practice includes a fundamental expectation that student feedback can be made actionable. Instructional rubrics can help to support student growth by providing them a progression of quality against which they can plan next steps. In this session, we will identify the characteristics of instructional rubrics and explore ways to engage students in using instructional rubrics.

4:45 p.m. – 5:45 p.m., Conference Room 3

Audience Code: G

### ***“Translations in Education Assessment Terminology”***

**Presenter: Juan F. Tituaña, MSDE**

Foreign language translations in educational assessment terminology need to be consistent for Spanish speaking parents and guardians. Sub-topics and content will include example of translations discrepancies, how to avoid use of non-sexist wording in language translation and ways to condense the translated target language to concise and simple sentences. Learn to effectively communicate to parents and guardians in different languages.

4:45 p.m. – 5:45 p.m., Conference Rooms 4 & 5

Audience Code: G

### ***“Building Effective Coaching Relations: Simple Strategies for Navigating Multiple Stakeholders”***

**Presenter: Regenna Jalón, Dorchester County**

The success of any group’s efficacy is the foundational relationships established among the members. In this session, simple strategies that nurture positive relationships will be shared. These strategies can improve trust, encourage communication, and foster confidence; thereby creating effective professional learning communities and improving collaboration with colleagues.

**WEDNESDAY, NOVEMBER 14, 2018**

4:45 p.m. – 5:45 p.m., Conference Room 6

Audience Code: M/H

***“Preparing a Quick Trip through PARCC”***

**Presenters: Kathleen Watkins & Lloyd Allen, Baltimore County**

We have a method to reduce the amount of time it takes to administer the PARCC exam. When we first started 3 years ago, PARCC took 7 weeks. This year, PARCC took 8 days, including make-ups.

5:45 p.m. – 7:00 p.m. **DINNER BUFFET** - Crystal Ballroom

7:00 p.m. – 8:00 p.m., Crystal Ballroom

**OPENING KEYNOTE ADDRESS**

***“Measuring What Matters”***

**Presenter: Jay McTighe, McTighe and Associates Consulting, Columbia, MD**

Jay McTighe will examine different types of goals for modern schooling (academic content based on standards, 21st century skills, and habits of mind); consider the assessment implications of these different goal types; critique a common, yet flawed, approach to test prep; examine ways of allowing students’ “voice and choice” in assessments while still obtaining needed evidence of important learning outcomes; explore a new conception of Curriculum Mapping (i.e., mapping the curriculum around desired performances rather than simply a scope and sequence of content to be covered); and examine the use of formative assessments to enhance student learning and performance.

This session is based on the ideas in “Three Key Questions on Measuring Learning,” Jay McTighe’s featured article in the February 2018 issue of *Educational Leadership* magazine, and his blog post, “Beware of Test Prep.”

8:00 p.m. – 10:00 p.m., Salon B

***Cocktail Reception***

**Sponsored by Pearson**

## **THURSDAY, NOVEMBER 15, 2018**

7:00 a.m. – 2:00 p.m.           **REGISTRATION** - Lower Terrace Lobby

7:15 a.m. – 8:30 a.m.           **BREAKFAST BUFFET** - Crystal Ballroom

8:30 a.m. – 9:30 a.m., Salon B

***“Designing Authentic Performance Tasks to Promote Meaningful Learning and Measure What Matters Most”***

**Presenters: Jay McTighe**

**Need Description**

8:30 a.m. – 9:30 a.m., Conference Room 1 & 2

Audience Code: M/H

***“Building a better Bridge: ELA Revised Projects”***

**Presenter: Kathleen Maher-Baker, MSDE**

Participants will discuss ELA Bridge Project expectations and review revisions made to the projects in the summer of 2018. These changes were a direct result of best practices, teacher input, and LEA feedback.

8:30 a.m. – 9:30 a.m., Conference Room 3

Audience Code: G

***“Charting the Course for the Use of Evidence in Education”***

**Presenter: Cheryl Ballou, Renaissance & Unknown, MSDE**

To manage effectively, you need to measure the right things. Those are the things that provide insight in the work performed, and that you are able to influence. This session will dive into what "evidence-based" decision making in education means and how teachers and administrators can use evidence accurately within ESSA guidelines.

8:30 a.m. – 9:30 a.m., Conference Rooms 4 & 5

Audience Code: G

***“Data Breach Simulation”***

**Presenter: Eric Gray, The Privacy and Technical Assistance Center at the United States Department of Education**

Your school’s data has been breached. How, why, and what happens next? In this interactive session, you will step into the shoes of a district grappling with a data breach. From inception to conclusion, you will direct the course of the district’s response to the situation while the team from PTAC provides guidance, challenges and even changes the scenario on the fly to keep you guessing. Will you handle the situation appropriately or will your students’ data end up on the dark web?

8:30 a.m. – 9:30 a.m., Conference Room 6

Audience Code: M

***“Self-Assessment and Peer Feedback in the Student-Centered Classroom”***

**Presenters: David Warrenfeltz & Erica Hartley, Washington County** Audience Code: G

Teachers should not be the only assessors in a classroom! As teachers become adept as formative assessors, they face a new challenge. How do I keep up with all these assessments and data? Come learn about 8 easy to implement strategies to flip the assessment paradigm in your classroom!



## **THURSDAY, NOVEMBER 15, 2018**

9:45 a.m. – 10:45 a.m., Salon B

Audience Code: G

***“FAME, I’m Gonna Live Forever! Continuing Formative Assessment in Your School or District After FAME”***

**Presenter: Heather Sauers, MSDE**

Once FAME is over, schools and/or districts should consider how to sustain professional learning that continues to support the attributes of formative assessment. This session will focus on various differentiated pathways for schools and districts to focus on after FAME, as well as resources to support them. Pathways include learning targets and success criteria, feedback, peer coaching, collecting evidence of learning, differentiation, leadership support, and management.

9:45 a.m. – 10:45 a.m., Conference Room 1 & 2

Audience Code:

***“Open Office Hour with the Office of Accountability”***

**Presenters: Laia Tideman, Tim O’Quinn, Tracy Dusablon & Jennifer Wood, MSDE**

Bring those burning questions for the Office of Accountability staff during our Open Office Hours. Staff will be available on-site at MAG to discuss data collections and accountability. Central Office staff will have the opportunity to network, share their experience and successes, and resolve challenges with their current work with the Office of Accountability.

9:45 a.m. – 10:45 a.m., Conference Room 3

Audience Code: G

***“Zooming in on Understanding”***

Audience Code: G

**Presenters: Steven Van Rees & Jackie Jacobs, Calvert County**

This presentation will help students apply a parts-to-whole method of building understanding. A UDL-aligned framing technique of topics, ideas, and issues will be explored in the session. The framing techniques will allow for students to make their thinking visible and for teachers to make accurate assessments of understanding.

9:45 a.m. – 10:45 a.m., Conference Rooms 4 & 5

Audience Code: G

***“FERPA 101”***

**Presenter: Eric Gray, The Privacy and Technical Assistance Center at the USDE**

Join the U.S. Department of Education’s Privacy Technical Assistance Center for an introductory presentation on the Family Education Rights and Privacy Act. This presentation will introduce you to the fundamentals of the 40-year old privacy statute, and provide depth and clarity on its application to the 21st century school and classroom! This session is intended as an introduction to the law and seeks to balance the legal background of the statute with real-world scenarios.

9:45 a.m. – 10:45 a.m., Conference Room 6

Audience Code: G

***“Supporting Data Use Through Peer Coaching”***

**Presenter: Lesley Beavers, MSDE**

Learn about the peer coaching process as a tool for professional learning and instructional improvement. See how data can be interwoven into coaching. Examples will be shared from around the state.

## **THURSDAY, NOVEMBER 15, 2018**

11:00 a.m. – 12:00 p.m., Salon B

Audience Code: M

### ***“What’s New in Social Studies Assessment?”***

**Presenters: Leah Renzi & Beth Ann Haas, MSDE**

Presenters will provide an overview of the shifts in limits, design and goals of the HSA. in American Government and upcoming grade 8 United States History assessment.

11:00 a.m. – 12:00 p.m., Conference Room 1 & 2

Audience Code: G

### ***“The Sharing Economy for Digital Assessments: Increasing Quality and Decreasing Cost with Open Standards, Open Source Software, and Open Collaboration”***

**Presenter: Dale Cornelius, MSDE**

As state and district student assessment programs support 100% online, digital formats opportunities for collaboration and sharing of resources arise. Through the use of open technology standards, open source platforms, and open collaboration practices states and districts can increase the quality of student assessment while reducing program costs.

11:00 a.m. – 12:00 p.m., Conference Room 3

Audience Code: M

### ***“Informing Middle Level Instruction and High School Course Selection”***

**Presenter: Martha Morris, College Board**

Come and learn the structure and content of the PSAT 8/9 directed to 8th and 9th grade students. Generate ideas for using the PSAT 8/9 to inform instruction. The session will also touch on the professional development modules and supports available for middle school educators.

11:00 a.m. – 12:00 p.m., Conference Rooms 4 & 5

Audience Code: H

### ***“Development and Use of College and Career Readiness Dashboards Among High Schools”***

**Presenter: Laura E. Bush, Baltimore City Public Schools**

City schools’ dynamic “On Track to Graduation and College and Career Readiness Dashboards” are used to support College and Career Readiness in grades 9-12. It takes data-driven decisions to the next level by providing real time student data on overall trends specific to graduation attainment and research-based post-graduate success to identify appropriate interventions.

11:00 a.m. – 12:00 p.m., Conference Room 6

Audience Code: E

### ***“Growing Student Writers Using Formative Assessments”***

**Presenters: Kelly Cleland, Julie Donovan, & Amy Siracusano, Calvert County**

Written expression and language usage are critical in supporting student achievement. Using the MD-CCSS writing standards, teachers can develop data tools to inform daily writing instruction and monitor student progress. Data collected and monitored is used to develop teacher SLO’s and support on-going professional development.

**THURSDAY, NOVEMBER 15, 2018**

12:00 p.m. – 1:00 p.m.      **LUNCH BUFFET**, Crystal Ballroom

1:00 p.m. – 1:50 p.m. Crystal Ballroom

***Need Title***

**Presenter: Marnie Stockman, Performance Matters**

***Need Description***

2:00 p.m. – 2:45 p.m., Exhibit Hall, Salon A

**Dessert and Beverages**

**Vendor Discussions and Door Prizes**

*Must Be Present to Win!!!!*

2:45 p.m. – 3:45 p.m., Salon B

Audience Code: G

***“Are you Data and Assessment Literate?”***

**Presenter: Jamie Bowers, MSDE**

***NEED DESCRIPTION***

2:45 p.m. – 3:45 p.m., Conference Room 1 & 2

Audience Code: M/H

***“Thinking and Computer Science Standards – Oh, my!”***

**Presenters: Debby Ward & Val Emrich, MSDE**

Participants will engage in a hands-on activity designed to develop a deeper understanding of the ESSA requirement related to Computational Thinking/Learning. Through examination of and discussions around Maryland’s new Computer Science Standards, participants will understand how the Standards and Computational Thinking connect.

2:45 p.m. – 3:45 p.m., Conference Room 3

Audience Code: M/H

***“Making the Most of the SAT Suite of Assessments in your School”***

**Presenter: Martha Morris, College Board,**

This session will cover a review of the SAT; the Reporting Portal and what reports are good for you; the supports such as Official SAT practice with Khan Academy, and how we can help you provide the right supports for your students taking the PSAT and SAT.

## **THURSDAY, NOVEMBER 15, 2018**

2:45 p.m. – 3:45 p.m., Conference Rooms 4 & 5

Audience Code: G

### ***“The Accelerated Learning Process - Transforming Teaching and Learning through Ongoing Collaboration and Job-Embedded Professional Learning”***

**Presenters: Kelly Taylor & Jennifer Bingman, Frederick County**

The Accelerated Learning Process is a systemic process for ongoing, job-embedded professional learning, educator collaboration, and continuous evaluation of student learning. We'll explain how this process transforms teaching and learning when teams regularly monitor student learning, administer data-driven decisions, differentiate instruction, share instructional best practices, and examine student work.

2:45 p.m. – 3:45 p.m., Conference Room 6

Audience Code: R

### ***“Standard Setting for New District Assessments”***

**Presenter: Helen Wang, Montgomery County**

Introduction and reflection of the standard setting process for new district assessments, including establishment of expert panels, training provided for panelists, standard setting protocol, item analysis, field testing, cut scores estimation using Angoff method, impact analysis, and validity study.

4:00 p.m. – 5:00 p.m., Conference Room: Salon B

Audience Code: G

### ***“Effective Data Analysis for School Improvement Planning”***

**Presenters: Patricia Crafton & Gail Clark Dickson, MSDE**

The presentation will discuss decision-driven data collection and analysis as it relates to completing a needs assessment, a root cause analysis, and school improvement planning. Participants will receive an overview of available tools and publications available, along with an understanding of current frameworks and practices in use within Maryland.

4:00 p.m. – 5:00 p.m., Conference Room 1 & 2

Audience Code: G

### ***“Fostering a Growth Mindset & Getting Results at a 2017 National Blue-Ribbon Elementary School”***

**Presenters: Judith Wilson & Pam Strauss, Montgomery County**

Discover how one can embrace a growth mindset to get results when students utilize learning logs and goal-setting practices based on their data. Children's picture books having various growth mindset aspects will be shared along with strategies for supporting 21st century teaching and learning. Walk-away with a bibliography of books!

4:00 p.m. – 5:00 p.m., Conference Room 3

Audience Code: M

### ***“Learning from Leaders – Creating a Can-Do Culture of Data that Gets Results”***

This session is repeated on Friday

**Presenter: Sonya Coleman, Curriculum Associates**

Explore the power of data to transform school culture and build the “significant relationships” at the heart of true personalization. This conversation includes suggestions on how to shift to a growth-focused school environment that honors and celebrates the march toward proficiency, as well as specific examples of success from **(local MD district)** and Miami-Dade, FL

4:00 p.m. – 5:00 p.m., Conference Rooms 4 & 5

Audience Code: M/H

***“Coaching Teachers to Obtain Student Growth Through the Use of Standards, PARCC Evidence Statement Reports and Formative Assessments”***

**Presenter: Julie Morrison & Joe Sutton, Calvert County**

Calvert County teachers who use the PARCC Evidence statements, performance level descriptors, and on-going formative assessment to guide instructional choices saw greater student growth than their peers. Learn the coaching protocols used to show teachers how to drill down from PARCC evidence statements to make daily instructional choices that move students toward mastery of rigorous standards.

4:00 p.m. – 5:00 p.m., Conference Room 6

Audience Code: M/H

***“Why wait until May?”***

**Presenters: Brittney Baker & Samantha Wasson, Dorchester County**

An Algebra I CC initiative that two Champion teachers launched based on a challenge set by their instructional mathematics coach. The Why wait until May initiative is about instilling PARCC Best Practices as soon as students arrive in September! This presentation will outline the team’s journey.

5:30 p.m. – 7:00 p.m., Salon B

**Cocktail and Social Hour**

**In Appreciation of Conference Participants**

***Sponsored by the Clarion Resort & Conference Center***

6:30 p.m. – 8:00 p.m. **DINNER**, Crystal Ballroom

***Sponsored by Pearson***

8:00 p.m. – ?

**MAG NIGHT AT THE CLARION**

Horizon’s Restaurant

**FRIDAY, NOVEMBER 16, 2018**

7:00 a.m. – 8:00 a.m.      **COFFEE AND DANISH**  
Upper Terrace Lobby

7:00 a.m. – 10:00 a.m.      **REGISTRATION**  
Lower Terrace Lobby

8:00 a.m. – 9:00 a.m., Salon B      Audience Code: G  
***“Shift Happens - Moving from PARCC to MCAP”***

**Presenters: Pauline Carey, MSDE & Andi Tompkins and Jeff Heathman, Pearson**

A discussion with Pearson and MSDE regarding changes to assessments as Maryland transitions to the Maryland Comprehensive Assessment Program (MCAP) with aligned tools to support. ELA/Literacy, Math and Science assessments. Discussion will focus on a new MCAP information portal, modifications to user roles and the registration data layouts in PearsonAccessNext.

8:00 a.m. – 9:00 a.m., Conference Room 1 & 2      Audience Code: E  
***“Using Evidence Statements to Inform Grade Level and Classroom Instruction”***

Audience Code: E

**Presenters: Jennifer Young & Dawn Caine, Calvert County**

Participants will be guided through a process that can be used with grade level teams to walk them through using the Evidence Statement Reports and web-based tools to drill down to the instructional needs of their school and grade levels. A copy of the step-by-step facilitator guide will be available.

8:00 a.m. – 9:00 a.m., Conference Room 3      Audience Code: G  
***“Building Student Ownership through Teaming”***

**Presenters: Shawn Parks & Jackie Murray, Caroline County**

Two middle school teachers will discuss strategies to teach students how to hold themselves and their teammates accountable for their learning based on the research of Dr. Michael Toth and Learning Sciences International. This session will highlight LSI tools in addition to teacher-created supplemental activities, both of which have been used to increase student ownership of learning. Gain knowledge and practical applications you can implement in your own classroom.

8:00 a.m. – 9:00 a.m., Conference Rooms 4 & 5      Audience Code: E  
***“Testing Without Tears”***

**Presenter: Jamie Morrow, Anne Arundel County**

During this interactive session, participants will examine methods that can be used in the classroom to prepare students for the demands of an assessment without teaching to the test; as well as, ways to assess student learning using authentic experiences that focus on movement, collaboration, and engagement.

## **FRIDAY, NOVEMBER 16, 2018**

8:00 a.m. – 9:00 a.m., Conference Room 6

Audience Code: G

### ***“Learning from Leaders – Creating a Can-Do Culture of Data that Gets Results”***

This session is a repeated from Thursday

**Presenter: Sonya Coleman, Curriculum Associates**

Explore the power of data to transform school culture and build the “significant relationships” at the heart of true personalization. This conversation includes suggestions on how to shift to a growth-focused school environment that honors and celebrates the march toward proficiency, as well as specific examples of success from **(local MD district)** and Miami-Dade, FL

9:15 a.m. – 10:15 a.m., Salon B

Audience Code: G

### ***“Next Generation Science Standards as a Tool to Guide SLOs and Science Instruction”***

**Presenter: Ed Mitzel, & Brian Eyer, MSDE**

Participants (supervisors, principals, and lead teachers) will use the Next Generation Science Standards to inform and guide the development of science Student Learning Objectives, three dimensional science classroom instruction, and a comprehensive science program in your school. Learn about tools and resources to support your work in schools.

9:15 a.m. – 10:15 a.m., Conference Room 1 & 2

Audience Code: G

### ***“Using Multiple Measures to ensure Equity and Access in Courses”***

**Presenters: Caryn Maxwell, Carla Britt, & Shoua Moua, Montgomery County**

Starting with a guiding question or problem of practice, participants will experience how a data analytics platform can efficiently combine multiple assessment measures to analyze access and equity in courses.

9:15 a.m. – 10:15 a.m., Conference Room 3

Audience Code: M/H

### ***“Evidence-based Literacy Practices from “Cracking the Common Core”***

**Presenters: Sherry Eichinger-Wilson & Sara Merkle, Cecil County**

An exploration of the well-established research-based literacy practices from “Cracking the Common Core” that are a cornerstone of Cecil County’s Common Core-aligned curriculum. The session will cover how effective literacy practices allow students to become capable readers who engage with complex texts and meet the demands of the Common Core.

9:15 a.m. – 10:15 a.m., Conference Rooms 4 & 5

Audience Code: G

### ***“Have you ever struggled with unpacking data? Got Protocols?”***

**Presenters: Sarah Crisman, Jennifer Neidenbach, & Pamela Stewart, Prince George's County**

In this session, we will explore different types of data protocols to assist with our understanding and the use of data to move instruction. This session will be hands-on and full of discussion.

**FRIDAY, NOVEMBER 16, 2018**

9:15 a.m. – 10:15 a.m., Conference Room 6

Audience Code: G

***“Lessons Learned from Building Aligned Curricular Frameworks in Literacy”***

**Presenters: Bonnie Hain, CenterPoint Education Solutions; Dee Shorts, Worcester County; & TBD District staff member, Ft. Wayne Community Schools (IN)**

In this session, participants will hear from district staff at Worcester County Public Schools (MD) and Fort Wayne Community Schools (IN) about their approach to working with educators to build curricular units and interim/benchmark assessments and the materials needed to support implementation of college- and career-ready standards.

10:15 a.m. – 11:15 a.m.

**BRUNCH and ANNOUNCEMENTS, Crystal Ballroom  
Sponsored by**

11:15 a.m. – 12:30 p.m., Crystal Ballroom

**CLOSING KEYNOTE ADDRESS**

**Presenter: Jennifer Judkins, Assistant State Superintendent, MSDE  
Division of Assessment, Accountability, and Information Technology**

Learn about the vision for the new Maryland Comprehensive Assessment Program (MCAP) including computer adaptive testing (CAT) and the opportunities for educators to be involved throughout the assessment development process.



**FAREWELL, GRAND PRIZE DRAWING, AND PROFESSIONAL DEVELOPMENT  
CERTIFICATES WILL BE GIVEN AFTER KEYNOTE ADDRESS**

*Must be present to win!*



***Make plans for next year's conference!  
MAG November 6-8, 2019***

# MEETING & BANQUET FACILITIES

## First Floor

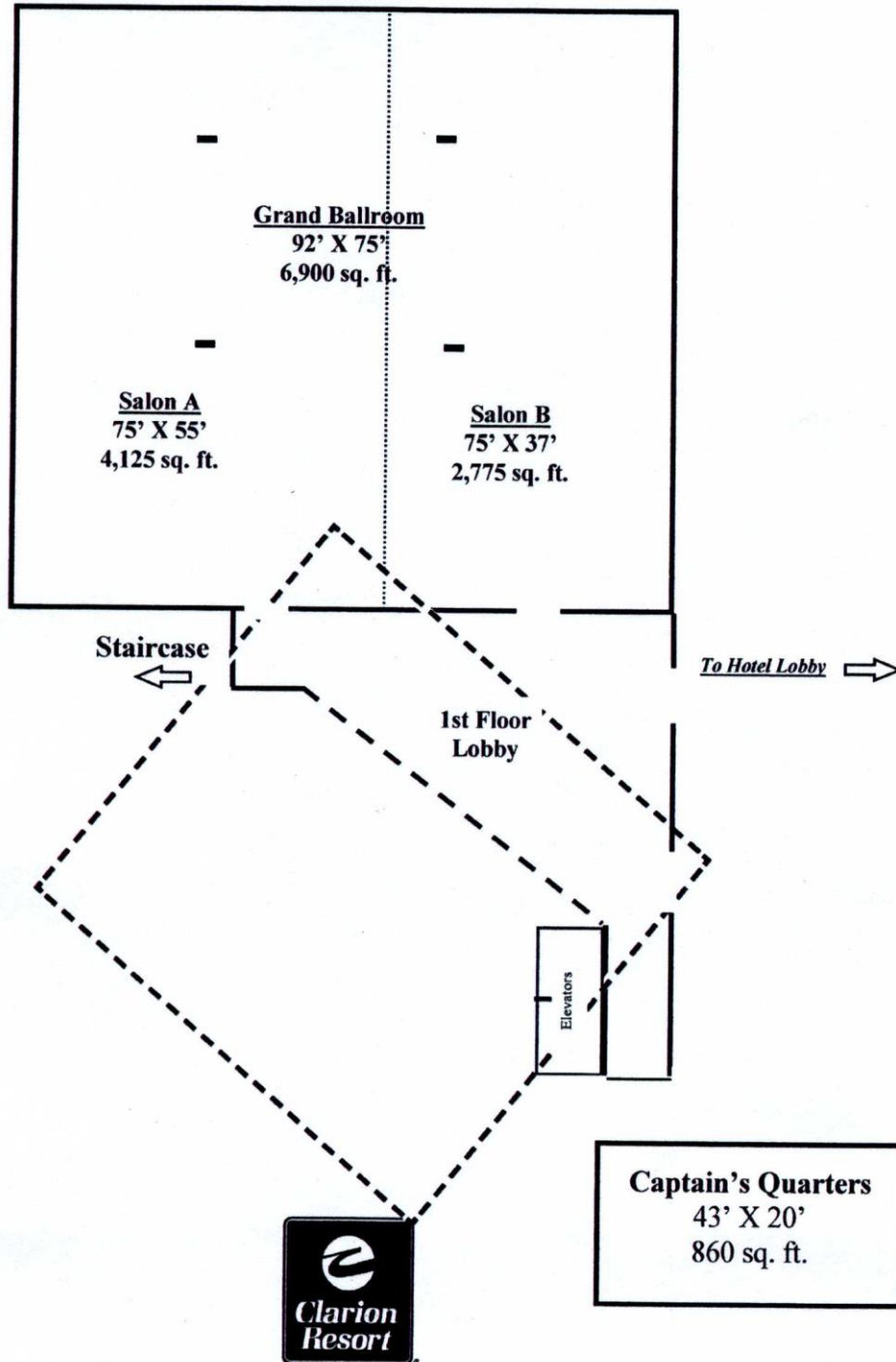

# MEETING & BANQUET FACILITIES

## Second Floor

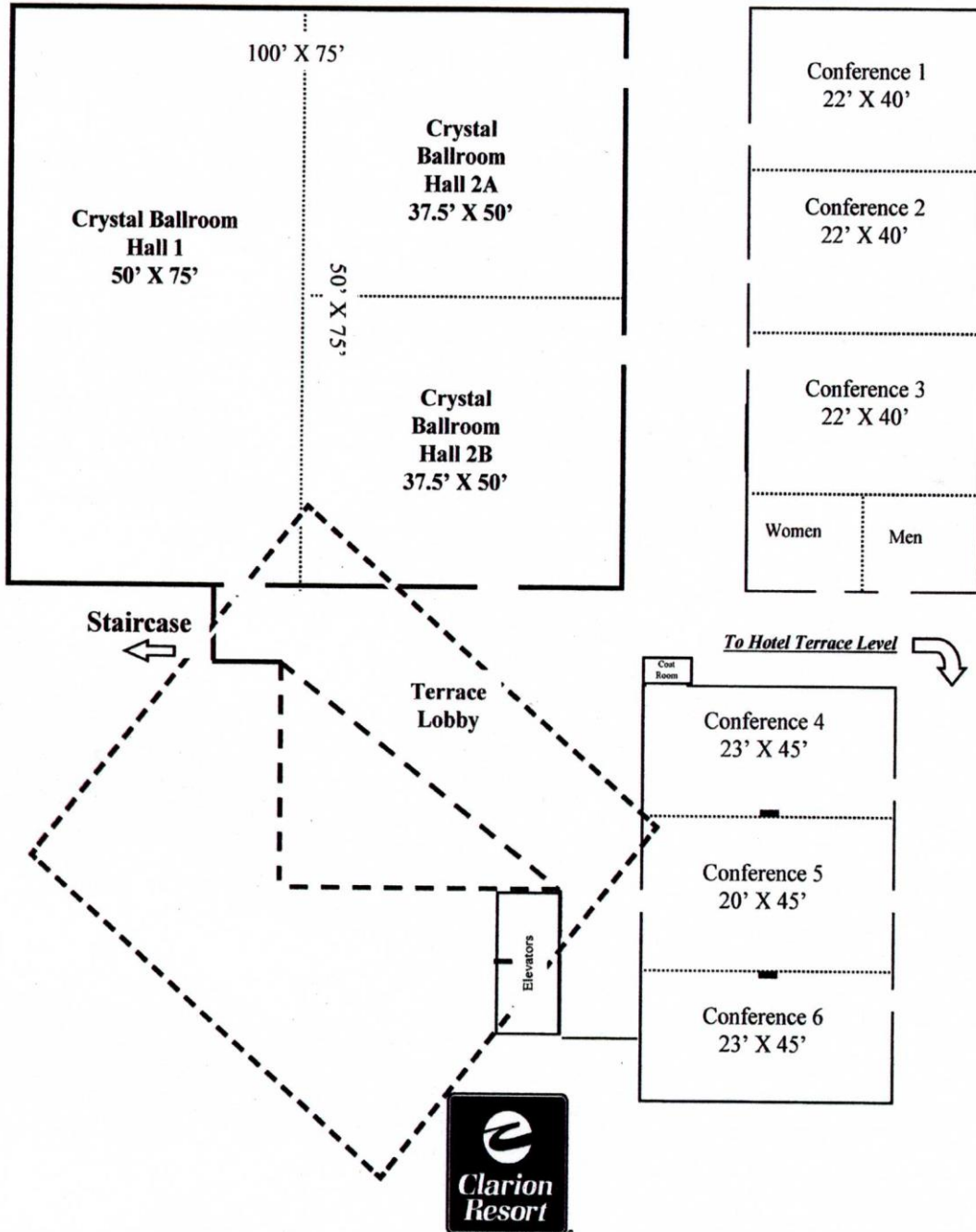

## **Participating Vendors and Sponsors**

*Please visit our vendors and sponsors throughout the conference in the Vendor Exhibit Hall  
Salon A*