



# **Formative Foundations, Summative Conclusions**

**Maryland Assessment Group  
2016 Annual Conference**

**November 16-18, 2016  
Clarion Resort & Conference Center  
Ocean City, Maryland**

Join us on [Twitter](https://twitter.com/MDAssessmentGrp) - <https://twitter.com/MDAssessmentGrp>  
Facebook - <https://www.facebook.com/mdassessmentgroup>

---

Join us on [Twitter](https://twitter.com/MDAssessmentGrp) - <https://twitter.com/MDAssessmentGrp>  
Facebook - <https://www.facebook.com/mdassessmentgroup>

**MARYLAND ASSESSMENT GROUP  
ANNUAL CONFERENCE**

**NOVEMBER 16-18, 2016  
CLARION RESORT & CONFERENCE CENTER  
OCEAN CITY, MARYLAND**

**MAG BOARD OF DIRECTORS**

Deborah Gilmartin  
Melissa Mulligan  
Heather Lageman

Julian Katz, Executive Director  
Deborah Gilmartin, Program Director

**The MAG Board of Directors wishes to thank the following sponsors for  
their financial support which reduces the cost of this conference for  
Maryland educators.**

Pearson Assessment  
Educational Testing Service  
Learning Sciences  
Performance Matters  
SchoolCity  
Curriculum Associates  
Lexia Learning  
Northwest Evaluation Association  
Renaissance Learning  
Turnitin  
The College Board

*Conference arrangements provided by CONFERENCE SOLUTIONS*

Join us on [Twitter](https://twitter.com/MDAssessmentGrp) - <https://twitter.com/MDAssessmentGrp>  
Facebook - <https://www.facebook.com/mdassessmentgroup>



**PRE-CONFERENCE SESSION**  
**Wednesday, November 16<sup>th</sup>, 10:30 – 3:15**  
Salon B, Admission Ticket Required

***“Embedding Formative Assessment”***  
**Presenter Dr. Dylan Wiliam**  
**Sponsored by Learning Sciences**

There is now a large and growing body of evidence that helping teachers develop their use of minute-to-minute and day-by-day assessment is the most powerful way to improve student learning. Adopting formative assessment involves far more than adding a few “quick fixes” to teachers’ classroom repertoires. Assessment for learning involves a fundamental shift in focus - from what the teacher is putting *into* the process - to what the students are getting *out* of it.

**10:30 a.m. – 12:00 p.m.**

- Why formative assessment needs to be the priority for every school
- Formative assessment: what it is and what it isn’t
- Strategies and practical techniques for formative assessment (Part 1)

**12:00 p.m. – 12:45 p.m. LUNCH**

**1:00 p.m. – 2:30 p.m.**

- Strategies and practical techniques for formative assessment (Part 2)
- Sustaining professional learning with teacher learning communities

**2:30 p.m. – 3:15 p.m. Book Signing**

#### **About Dylan Wiliam**

Dylan Wiliam, PhD, is one of the world’s foremost education authorities. He has helped to successfully implement classroom formative assessment in thousands of schools all over the world, including the United States, Singapore, Sweden, Australia, and the United Kingdom. Dylan Wiliam is Emeritus Professor of Educational Assessment at the Institute of Education, University of London. After a first degree in mathematics and physics, he taught in urban schools for seven years, during which time he earned further degrees in mathematics and mathematics education.

Dylan Wiliam, PhD, has partnered with Learning Sciences International on an exciting professional development initiative for teachers and school administrators, the primary goals being:

- To help schools fortify strategic formative assessment with teacher learning communities
- To research and develop innovative, highly effective programs
- To support enhanced student achievement with cutting-edge technology

Dr. Wiliam is an internationally recognized leader in the development of effective, research-based formative assessment. His books, articles, school visits, workshops, and conference presentations on strategic formative assessment and teacher learning communities have profoundly impacted teacher professional practice and student learning worldwide.

Join us on [Twitter](https://twitter.com/MDAssessmentGrp) - <https://twitter.com/MDAssessmentGrp>  
Facebook - <https://www.facebook.com/mdassessmentgroup>

# Formative Foundations, Summative Conclusions

**WEDNESDAY, NOVEMBER 16, 2016**

9:00 a.m. – 9:00 p.m.

**REGISTRATION**

Lower Terrace Lobby

10:30 a.m. – 3:15 p.m.

**PRE-CONFERENCE SESSION**

Conference Rooms 1&2

Ticket Required for Admission – See description, opposing page

**VENDOR DISPLAYS IN THE VENDOR EXHIBIT HALL:**

Starting on Wednesday, November 16, 2016 at 3:30 p.m. and closing on Thursday, November 17, 2016 at 5:00 p.m.

**AUDIENCE FOCUS CODES:**

E= Elementary School

G=General, Geared to All

M=Middle School

R= Research

H= High School

3:30 p.m. - 5:45 p.m., Salon B

**Local Accountability Coordinators' Meeting**

**Led by Doug Strader, MSDE**

Local Accountability Coordinators and MSDE staff will gather for a formal state meeting.

3:30 p.m. - 4:30 p.m., Conference Room 1

Audience Code: G

***“The Role of Feedback in the Assessment Process - Eliminating the Red Pen!”***

**Presenters: Kanika Dorsey & Ava Spencer, MSDE**

Feedback is a necessary component of the process for formative assessments. A good formative assessment gives information to the teacher about every student's progress. The students learn how they are doing in relation to classroom learning goals. This session will discuss ways to give effective feedback to students.

3:30 p.m. - 4:30 p.m., Conference Room 2

Audience Code: E, M

***“Writing Across the Curriculum – Now You Want Me to Teach Writing Too?!”***

**Presenter: Donna Miller, Calvert County**

Students should be writing in every content area. Writing is thinking and that is what students are expected to do across the curriculum. Learn how writing can help build and demonstrate knowledge in each content area. This session will provide writing strategies and share student samples of writing in reading, mathematics, science, and social studies.

Join us on [Twitter](https://twitter.com/MDAssessmentGrp) - <https://twitter.com/MDAssessmentGrp>

Facebook - <https://www.facebook.com/mdassessmentgroup>

## WEDNESDAY, NOVEMBER 16, 2016

3:30 p.m. - 4:30 p.m., Conference Room 3

Audience Code: G

### ***“Multi-Purpose Assessments”***

**Presenter: Jim Tilghman, Northwest Evaluation Association**

In these days of "too much testing" it is increasingly important that assessments are multi-functional. Join us for a discussion about assessment that will drive instruction, measure growth, predict for PARCC and CCR, and provide placement direction and more.

3:30 p.m. – 5:30 p.m., Conference Rooms 4 & 5 (2 hour session)

Audience Code: G

### ***“From Large Scale Assessment to the Classroom: Use Summative Data to Improve Instruction”***

**Presenters: Melissa Finkel & Jaime Bowers, MSDE**

MSDE staff will share PARCC Reports and familiarize the audience with the variety of data reports offered by PARCC. Participants will have the opportunity to analyze one set of reports and discuss how that data can be used to make instructional decisions.

3:30 p.m. - 4:30 p.m., Conference Room 6

Audience Code: G

### ***“Formative Feedback for Summative Growth”***

**Presenters: Patti West-Smith, & Melissa Perlman, Turnitin**

Formative feedback is the key to improving student's writing performance. They must write often, but more importantly, they must be taught to revise. Revision without feedback won't help students grow. Feedback must be returned rapidly so that it is still relevant. How can even the best teacher provide timely, relevant, actionable feedback for every student? We'll dive into why, what, and how in this presentation.

4:45 p.m. – 5:45 p.m., Conference Room 1

Audience Code: H

### ***“ELA Bridge Projects: Everything You Wanted to Know but Didn't Even Know to Ask”***

**Presenters: Kathleen Maher-Baker, Ava Spencer, & Kanika Dorsey, MSDE**

This presentation will provide an overview of the new Bridge Plans in English Language Arts. Participants will review old projects and discuss the evolution of new ones. The Project pilot groups and how student and teacher feedback guided the revision of the projects will be addressed.

4:45 p.m. – 5:45 p.m., Conference Room 2

Audience Code: G

### ***“Formative Assessment is Not Part of ‘Over Assessment’: Inform Instruction and Differentiate for Every Student”***

**Presenter: Jordan Savitt, Renaissance**

Participants will join in an exploration of extensive research on formative assessment, an essential element in promoting educator effectiveness. Practical ideas for application will be offered as well on the challenges teachers face in differentiating for EVERY student and how administrators can support them in their efforts.

**WEDNESDAY, NOVEMBER 16, 2016**

4:45 p.m. – 5:45 p.m., Conference Room 3

Audience Code: E

***“Getting Primary Students Ready for PARCC”***

**Presenter: D’Nia Walker, Anne Arundel County**

This presentation will discuss K-2 Maryland College and Career Readiness Mathematics standards aligned with the 3rd grade PARCC assessment. This professional learning session will be interactive using hands-on materials to introduce instructional strategies educators can use to get primary students prepared for PARCC style questions.

3:30 p.m. – 5:30 p.m., Conference Rooms 4 & 5 (2 hour session)

Audience Code: G

***“From Large Scale Assessment to the Classroom: Use Summative Data to Improve Instruction”  
(Continued)***

4:45 p.m. – 5:45 p.m., Conference Room 6

Audience Code: G

***“From SLOs to Personalized Professional Development. How?”***

**Presenters: Lisa Bachner & Dawn Pipkin, St. Mary’s County**

Come see how LMS has connected our work with SLO’s and how we are now transitioning to personalized professional development in order to bridge the conversation between data, instruction, and teacher effectiveness.

5:45 p.m. – 7:00 p.m. **DINNER BUFFET - Crystal Ballroom**

**Sponsored by Performance Matters**

7:00 p.m. – 8:00 p.m., Crystal Ballroom

**OPENING KEYNOTE ADDRESS**

***“Leadership for Teacher Learning”***

**Presenter: Dr. Dylan Wiliam**

**Sponsored by Learning Sciences**

There is now substantial evidence that there is a “knowing-doing” gap in education. The problem is not that we do not know how to improve schools. The problem is implementing what is known to work in more classrooms. This is why approaches based on “sharing good practice” have been relatively ineffective. Helping teachers develop what they do in classrooms is more a process of habit change than of knowledge acquisition, which requires different kinds of teacher professional development, and draws on a different research base.

8:00 p.m. – 10:00 p.m., Salon B

***Cocktail Reception***

**Sponsored by Pearson**

**THURSDAY, NOVEMBER 17, 2016**

7:00 a.m. – 2:00 p.m.      **REGISTRATION** - Lower Terrace Lobby

7:15 a.m. – 8:30 a.m.      **BREAKFAST BUFFET** - Crystal Ballroom

8:30 a.m. – 9:30 a.m., Salon B      Audience Code: G  
***“ESSA: Accountability in Maryland”***

**Presenter: Chandra Haislet, MSDE**

Attendees will learn about the accountability requirements under the Every Student Succeeds Act (ESSA). Presenters will compare and contrast the differences between ESSA and No Child Left Behind (NCLB). The development of Maryland’s accountability program will be shared and reviewed.

8:30 a.m. – 9:30 a.m., Conference Room 1      Audience Code: G  
***“Coaching Teachers for College and Career-Ready Success”***

**Presenters: Cheryl Krehbiel and Diana Richie, New Teacher Center**

Only by accelerating the effectiveness of teachers and school leaders can we expect to realize significant improvement in teacher retention and student learning. Using New Teacher Center’s proven research, job-embedded strategies, and useful tools, participants will be provided with actionable steps they can take to support observing, coaching, and mentoring in their schools.

8:30 a.m. – 9:30 a.m., Conference Room 2      Audience Code: G  
***“An Overview of Changes in PearsonAccess Next and TestNav - A Discussion with Pearson”***

**Presenters: Rebecca Hoeft & Jeff Heathman, Pearson**

Join Pearson to learn about recent and upcoming changes to technology and products used to administer the PARCC assessments online. This will include a demonstration of changes in PearsonAccess Next and TestNav, as well as the upcoming technology release schedule. After reviewing the changes to technology, Pearson will give participants an opportunity to ask questions.

8:30 a.m. – 9:30 a.m., Conference Room 3      Audience Code: G  
***“Making It Work: Assessing Maker Projects”***

**Presenters: Casey Kirk, MSDE & Kimberly Johnson, Carroll County**

This presentation will focus on best practices for assessing maker projects, such as maker fairs and digital portfolios. It will include sample rubrics and planning guides. We will also examine how to assess maker mindset skills and 21st Century skills.

8:30 a.m. – 9:30 a.m., Conference Rooms 4 & 5      Audience Code: G  
***“Reflections from 20 Years as a Data Coach: What do We Know? What Do We Have to Learn?”***

**Presenter: Ronald S. Thomas, Towson University**

This session will include insights from Dr. Thomas’ 20 years as a data coach in Maryland’s schools. Why are meaningful dialogue and ongoing instructional adjustment more important than ever before? What should schools do to ensure that every collaborative team is skillful in these areas? Participants will interact with each other and the presenter.

Join us on [Twitter](https://twitter.com/MDAssessmentGrp) - <https://twitter.com/MDAssessmentGrp>  
Facebook - <https://www.facebook.com/mdassessmentgroup>



## **THURSDAY, NOVEMBER 17, 2016**

8:30 a.m. – 9:30 a.m., Conference Room 6

Audience Code: E

***“Applying the Attributes of Formative Assessment to Meet the Needs of Gifted and Talented Learners”***

**Presenters: Bruce Riegel, MSDE & Jessica Reinhard, Elizabeth Baumgardner, Ann Dunn, & Alexandra Pecsco, Washington County**

Early talent development promotes equity in the identification of diverse youth for GT education programs and is supported through COMAR. One such program, Primary Talent Development (PTD), trains and assesses all PreK-2 students in seven learning behaviors associated with potential and advanced capabilities. Learn how PTD supports and extends the MCCRS through content, assessments, and strategies.

9:45 a.m. – 10:45 a.m., Salon B

Audience Code: R

***“FERPA 101 and Disclosure Avoidance Training”***

**Presenter: PTAC, US Ed**

Staff from the Privacy Technical Assistance Center (PTAC) within the U.S. Department of Education will present about data privacy, confidentiality, and security practices related to student data. Discuss real-life scenarios on FERPA and its applicability to your institution. Receive an overview of best practices and staff training in the area of disclosure avoidance methodology and public reporting. Participants have an opportunity for interactive questions and answers.

9:45 a.m. – 10:45 a.m., Conference Room 1

Audience Code: M, H

***“Using PARCC Tasks to Inform Instructional Decisions”***

**Presenter: Kathryn Belmonte, Caroline County**

How can you capitalize on the use of released PARCC tasks in your classroom? First, we will relate student work samples to learning progressions and PARCC performance level descriptors. Then, we will discuss instructional implications through the lens of formative assessment.

9:45 a.m. – 10:45 a.m., Conference Room 2

Audience Code: M

***“Making Data Actionable – A Guide for Connecting PARCC Data to Blended Instruction”***

**Presenters: Woody Paik, Ken Tam, & Kristopher Johns, Curriculum Associates**

Rationalizing and acting on assessment data require (1) ensuring it reflects PARCC; (2) clear connections to digital and print instruction; and (3) a single platform that provides formative, predictive, and standards-based data. This presentation will focus on how this approach is being deployed in a growing number of school districts nationwide.

9:45 a.m. – 10:45 a.m., Conference Room 3

Audience Code: G

***“Ready, Set, Let’s Go Open!”***

**Presenter: Casey Kirk, MSDE**

What are Open Educational Resources? Where can you find them? Now, what do you do with them? In this interactive session, participants will be exposed to the tenets of the #GoOpen Movement. This includes discussions related to Open Educational Resources (OERs), an exploration of the Amazon Inspire repository, and how OERs align to assessments.

## **THURSDAY, NOVEMBER 17, 2016**

9:45 a.m. – 11:45 a.m., Conference Rooms 4 & 5 (2 hour session) Audience Code: G

### ***“Setting the Destination and Eliciting Evidence”***

**Presenter: Terry Morgan, LSI Dylan Wiliam Center**

This session focuses on establishing clear learning intentions and helping students understand the criteria for success. It is imperative for teachers to create a sequence of learning with a context free purpose and develop criteria to judge the success of learning. Participants will learn how to create a learning environment that produces successful, confident students and increased achievement as well as how these techniques fit into Dylan Wiliam’s 5 Strategic Formative Assessment Strategies.

9:45 a.m. – 10:45 a.m., Conference Room 6 Audience Code: G

### ***“Powering your Formative Assessment Analytics”***

**Presenters: Marnie Stockman & Beth Kawecki, Performance Matters**

Say Cheese! In the time it takes to snap a picture you can have the power of Performance Matters analytics for formative assessments. Through our Grade Cam integration, you can snap a picture of student bubble sheets OR through our online testing platform, students can take tests and teachers get quick results. Come see the latest ways teachers can use formative assessments to help students accelerate growth!

11:00 a.m. – 12:00 p.m., Salon B Audience Code: H

### ***“The Next Generation of Accuplacer”***

**Presenters: Keith Henry, The College Board**

Accuplacer, one of the assessment options for Senate Bill 740, is changing. Attend this session to understand Next Generation assessments: how they were designed, how they are changing, and resources to help students and teachers prepare for them. Discussion will include best practices for testing and intervention to improve students’ College & Career Readiness (CCR).

11:00 a.m. – 12:00 p.m., Conference Room 1 Audience Code: G

### ***“Twitter as Personalized Professional Development”***

**Presenter: Marcia Porter, Caroline County**

Learn how to harness the power of Twitter to grow your Professional Learning Network and create your own personalized professional development. Engage with other like-minded educators and become a leader as you chat, tweet, and retweet. BYOD and begin connecting, sharing, and learning. #MAG2016

11:00 a.m. – 12:00 p.m., Conference Room 2 Audience Code: G

### ***“Data Driven Intervention for Less than \$2.00 per Student Pays Off!”***

**Presenters: Debra Curdts, Aundrea Atwood, & Alexis Pogonowski, Anne Arundel County**

Discover how a simple notebook blends organization, study skills and note taking into a successful classroom intervention across all disciplines. Tracking "time on task" vs. assessments keeps students motivated to improve their classroom performance. Discovering the importance of organized notes and how to study became major outcomes of this intervention. Data results proved retention, engagement, and responsibility in a ninth grade focus group.

**THURSDAY, NOVEMBER 17, 2016**

11:00 a.m. – 12:00 p.m., Conference Room 3

Audience Code: G

***“Linking Thinking!”***

**Presenters: Pamela Mesta & Brian Wienholt, Carroll County**

In this interactive session, explore "Universal Thinking Verbs" and the cognitive complexity in the MCCRS and PARCC assessments. Fundamental thinking skills necessary for college and career success will be addressed. Cross-curricular connections and strategies will be discussed that promote a shared understanding of these essential thinking skills.

9:45 a.m. – 11:45 a.m., Conference Rooms 4 & 5 (2 hour session cont.)

Audience Code: G

***“Setting the Destination and Eliciting Evidence”***

11:00 a.m. – 12:00 p.m., Conference Room 6

Audience Code: M, H

***“A Simple Primer to Item Response Theory and Test Construction”***

**Presenter: Bruce Hislop, Prince George’s County**

The PARCC tests are built with Item Response Theory (IRT). What does that even mean? We will discuss the basics of the IRT model, why it leads to better, more informative tests, and how local systems and teachers can use IRT in the construction of system- and classroom-level tests.

11:00 a.m. – 5:00 p.m., Room 311

Audience Code: G

***“PTAC Student Privacy Professional Development Focus Group”***

**Presenter: PTAC, US Ed**

12:00 p.m. – 1:00 p.m.,

**LUNCH BUFFET**, Crystal Ballroom

1:00 p.m. – 1:50 p.m. Crystal Ballroom

**Sponsored by School City**

***“Focus on FAME: Washington County Public Schools Integrating Formative Assessments for Student Success”***

**Presenters: Maureen Margevich, Washington County & Lucy Long, SchoolCity**

Aligning curriculum modules with SchoolCity’s standards based item banks helped create formative assessments to enhance classroom instruction. Washington County now has a system that allows teachers to directly access pre-created standards and questions that directly align with our curriculum modules which fulfills our need for a comprehensive data management solution. Teachers use the collected data from formative assessments to create personalized learning groups for instruction and through SchoolCity can implement curriculum to identify and target student needs.

2:00 p.m. – 2:45 p.m., Exhibit Hall, Salon A

**Dessert and Beverages**

**Vendor Discussions and Door Prizes**

*Must Be Present to Win!!!!*

## **THURSDAY, NOVEMBER 17, 2016**

2:45 p.m. – 3:45 p.m., Salon B

Audience Code: R

### ***“Data Collections, Reporting, and More!”***

**Presenters: Matt Dammann, Laia Tideman, & Jaime Bowers, MSDE**

The Accountability Staff within the Division of Curriculum, Accountability and Assessment at MSDE will share updates on the status of current and upcoming data collections, changes in reporting, and anything else you would like to discuss! This session is intended for central office staff to understand the direction coming from MSDE in regards to data collection and reporting. Attendees will have an opportunity for interactive discussion and questions.

2:45 p.m. – 3:45 p.m., Conference Room 1

Audience Code: G

### ***“This is Our Time! How Can Schools and Districts Build 21st Century Skills through Computer Science?”***

**Presenters: Traci Chappellear, Charles County & Heather Lageman, Baltimore County**

Participants will discover how computer science develops students’ 21st century skills across three major outcome categories, including (1) Learning and Innovation; (2) Information, Media, and Technology; and (3) Life and Career. Meet district contacts from Maryland’s Professional Learning Partnership for Computer Science who will share how you can expand equity and access to high quality computer science courses for all students.

2:45 p.m. – 3:45 p.m., Conference Room 2

Audience Code: G

### ***“Peeling the Onion: ESOL, Special Education or Both?”***

**Presenters: Pamela Mesta & Gretchen Rockafellow, Carroll County**

Do you have English learners that you suspect may have a learning disability? Are you having a difficult time navigating the identification process? If so, this session is for you. Participants will learn new ways of identifying and documenting important information to help students succeed in the classroom. Ideas for interventions and applicable resources will be shared.

2:45 p.m. – 3:45 p.m., Conference Room 3

Audience Code: R

### ***“Collecting the Right Data to Inform Instruction”***

**Presenter: Amy Mozuch, Lexia Learning**

According to a 2015 report from the Bill and Melinda Gates Foundation, 93% of teachers regularly use some form of digital tool to guide instruction, but 67% percent say they are not fully satisfied with the effectiveness of the data or the tools for working with data that they have access to on a regular basis. To ensure that the right data is being collected, we need to ask the right questions, decide what data to gather, choose the collection tool, and collect and connect to instruction.

2:45 p.m. – 3:45 p.m., Conference Rooms 4 & 5

Audience Code: H

### ***“Stories Behind the College and Career Readiness Assessments”***

**Presenters: Cecilia Roe & Debby Ward, MSDE**

Understanding new requirements associated with the College and Career Readiness and College Completeness Act of 2013 can be quite challenging. Learn how the use of CCR assessments and transitions courses can help students make informed decisions about post-high school plans.

## **THURSDAY, NOVEMBER 17, 2016**

2:45 p.m. – 3:45 p.m., Conference Room 6

Audience Code: E

### ***“Assessing 21st Century Skills through the Arts”***

**Presenter: Ken Skrzysz, MSDE**

Participants will experience models of assessing 21st Century Skills (Communication, Collaboration, Creativity, and Critical Thinking) through a variety of fine arts' examples.

4:00 p.m. – 5:00 p.m., Conference Room: Salon B

Audience Code: G

### ***“Design Challenges and Solutions for Next Generation Science Assessments”***

**Presenters: Mary Thurlow & Ann Herrmann, MSDE**

This session highlights one state's design with rich simulations, and will include Maryland's design and plans for NGSS assessment programs, including a balanced assessment system and overall design for an online, summative performance assessment; pilot test results for rich science assessment simulations will be demonstrated.

4:00 p.m. – 5:00 p.m., Conference Room 1

Audience Code: G

### ***“Interpretive Listening of Student Work- In-Formative Assessment that Steers Instruction”***

**Presenter: Lisa Lienemann, Caroline County**

Interpretive listening, a concept in both Embedded and Embedding Formative Assessment, helps teachers become more nimble in adjusting instruction as students learn. Participants will view student work samples, practice interpretive listening moves, and discuss implications on student achievement. Planning resources to support interpretive listening also provided.

4:00 p.m. – 5:00 p.m., Conference Room 2

Audience Code: M

### ***“Guided Reading in the Middle School”***

**Presenters: Buffy Jordan & Becky Lamb, Anne Arundel County**

This session will highlight the implementation of guided reading using the language arts curriculum in sixth grade co-taught classes in Anne Arundel County. The logistics and professional development necessary to begin a successful program in a school will be discussed.

4:00 p.m. – 5:00 p.m., Conference Room 3

Audience Code: G

### ***“Using Formative Assessments to Drive Instruction”***

**Presenters: Jessica Tzucker, Achievement Network**

Achievement Network is a national nonprofit that supports over 700 schools in obtaining breakthrough results by using teaching practices grounded in standards and informed by data. Participants will learn how to use formative assessment data, PARCC released items, and student work to inform great instruction aligned to the rigor of CCSS.

4:00 p.m. – 5:00 p.m., Conference Rooms 4 & 5

Audience Code: G

### ***“Meeting the Needs of Teachers”***

**Presenters: Angela de Guzman, Cecilia Roe, & Dan Capozzi, MSDE**

“One size fits all” learning does not work for students and is not effective for educators trying to improve their professional skills and pedagogy. Discover the elements to personalized professional learning for educators, measure growth through personalized professional learning, and how teachers can document their learning for recognition.

**THURSDAY, NOVEMBER 17, 2016**

4:00 p.m. – 5:00 p.m., Conference Room 6

Audience Code: G

***“NAEP History and Updates”***

**Presenters: Melissa Finkel, MSDE**

In this informational session, learn about the history of the NAEP program, the 2017 administration, and how to interpret and analyze NAEP data. For LACs, school test coordinators, and administrators.

5:30 p.m. – 7:00 p.m., Salon B

**Cocktail and Social Hour**

**In Appreciation of Conference Participants**

**Sponsored by the Clarion Resort & Conference Center**

6:30 p.m. – 8:00 p.m. **DINNER**, Crystal Ballroom

8:00 p.m. – ? **MAG NIGHT AT THE CLARION**  
Horizon’s Restaurant

**FRIDAY, NOVEMBER 18, 2016**

7:00 a.m. – 8:00 a.m.

**COFFEE AND DANISH**

Upper Terrace Lobby

7:00 a.m. – 10:00 a.m.

**REGISTRATION**

Lower Terrace Lobby

8:00 a.m. – 9:00 a.m., Salon B

Audience Code: M, H

***“Earning College Credit by Exam in High School”***

**Presenter: Keith Henry, The College Board**

AP is not the only way to earn college credit by exam. College Board’s CLEP offers 33 exams which can be used in conjunction with AP or alone to earn credit. This session will discuss the basics of CLEP, resources for preparation, and steps to register for taking CLEP exams.

8:00 a.m. – 9:00 a.m., Conference Room 1

Audience Code: G

***“Our Journey towards Grading Smarter in a Student Centered Classroom”***

**Presenters: Linda Marchineck, Christine Roberts, & Maggie Cummins, Baltimore County**

This interactive session will focus on the BCPS journey to shift from a grading mindset to a learning mindset. We will discuss grading practices that promote and motivate student learning. The role of formative assessment and the power of effective feedback vs. getting a grade in our gradebook will be integrated throughout the session. Examples of the professional development activities used within our schools to being the grading transformation will be shared.

8:00 a.m. – 9:00 a.m., Conference Room 2

Audience Code: M, H

***“PARCC and WRITE”***

**Presenters: Ian Buter & Jack Tuttle, Charles County**

Learn how content area leads in Charles County Public Schools are providing sustainable professional development for teachers on the reading and writing literacy skills for the PARCC Assessments. This interdisciplinary approach helps teachers analyze and develop their own reading and writing tasks by identifying the instructional connections among subject areas.

8:00 a.m. – 9:00 a.m., Conference Room 3

Audience Code: G

***“Fostering a Growth Mindset & Getting Results”***

**Presenter: Judith Wilson, Montgomery County**

Fostering a growth mindset can impact student achievement in many ways. When students combine aspects of a growth mindset with goal setting, they track their own scores on MAP assessments and aim higher. See the tools teachers can use and ways to support success.

8:00 a.m. – 9:00 a.m., Conference Rooms 4 & 5

Audience Code: H

***“New Algebra I Bridge Project Process”***

**Presenters: Debby Ward & Nina Riggs, MSDE**

This session provides participants with an overview of the new Algebra I Bridge Project process. Participants will have a chance to review several Algebra I Bridge Project modules and to develop a better understanding of the new process via a question and answer segment.

## **FRIDAY, NOVEMBER 18, 2016**

8:00 a.m. – 9:00 a.m., Conference Room 6

Audience Code: G

### ***“Building Better Multiple Choice Items”***

**Presenter: Bruce Hislop, Prince Georges County**

The oft-maligned multiple choice test item can be incredibly powerful as a diagnostic tool as well as a summative tool. It also owns the title of most reliably scored test item type. We will discuss how to develop powerful multiple choice items which can then be banked for future use.

9:15 a.m. – 10:15 a.m., Salon B

Audience Code: H

### ***“Correlation between PARCC and other Academic Measures”***

**Presenter: Mei-Hui Wang, Anne Arundel County**

This study analyzes whether PARCC scores and levels are potentially valid tools for making inferences about college and career readiness across student subgroups in our school district. Students’ PARCC scores are analyzed to determine how well they correlate with other academic measures such as AP, ACT, PSAT, and SAT.

9:15 a.m. – 10:15 a.m., Conference Room 1

Audience Code: G

### ***“Getting Gritty with the Gap: Tenacious Teaching with Trusted EL Instructional/Assessment Strategies”***

**Presenters: Kristi Schmidt & Amy Cordes, Frederick County**

The ELA/Literacy Standards require students to read texts of particular levels of difficulty. For English Learners, this contradicts the notion of reading texts at their instructional level. Participants in this session will explore this conundrum and how the SIOP framework and various instructional and assessment strategies can allow students to access challenging texts and build language/literacy.

9:15 a.m. – 10:15 a.m., Conference Room 2

Audience Code: E

### ***“Lesson Study: A Powerful Professional Development Model”***

**Presenter: Regina Teat, Dorchester County**

Lesson Study is a professional development model that facilitates the instructional change process. Hear how Dorchester County began and continues to use this model to impact outcomes for student growth through the instructional change process.

9:15 a.m. – 10:15 a.m., Conference Room 3

Audience Code: G

### ***“What’s Next? What We Learned from PARCC to Develop High Quality District Assessments”***

**Presenters: Bonnie Hain, PARCC Inc.**

Over the course of developing PARCC, much has been learned about potential innovations in development of assessments to support educators as they gather information to inform instruction. In this presentation, one of the leaders in early development work for PARCC shares some of the innovations underlying the PARCC summative assessments and how these innovations can support district educators in their quest to develop high quality next generation district assessments.



**FRIDAY, NOVEMBER 18, 2016**

9:15 a.m. – 10:15 a.m., Conference Rooms 4 & 5

Audience Code: G

***“CRA Assessments - What are they? How can they help you better understand what your students know?”***

**Presenter: Linda Schoenbrodt, MSDE**

CRA Assessments (Concrete, Representational, and Abstract) are explained in the book, *Solving for Why*, by Dr. John Tapper. This session will review what the assessment is, how to develop it, and how to use the results to focus on the instructional needs of your students in mathematics.

9:15 a.m. – 10:15 a.m., Conference Room 6

VACANT

10:15 a.m. – 11:15 a.m.

**BRUNCH and ANNOUNCEMENTS**, Crystal Ballroom  
**Sponsored by ETS**

11:15 a.m. – 12:30 p.m., Crystal Ballroom

**CLOSING KEYNOTE ADDRESS**

***“A Message from the Assistant Superintendent of Curriculum, Assessment, and Accountability”***

**Dr. Carroll Visintainer**

Introduction by Doug Strader, Director of Assessment

**FAREWELL AND GRAND PRIZE DRAWING AFTER KEYNOTE ADDRESS**

*Must be present to win!*



***Make plans for next year's conferences!***

***Mini MAG, April 1, 2017***

***MAG November 15-17, 2017***

Join us on [Twitter](https://twitter.com/MDAssessmentGrp) - <https://twitter.com/MDAssessmentGrp>  
Facebook - <https://www.facebook.com/mdassessmentgroup>

# MEETING & BANQUET FACILITIES

## First Floor

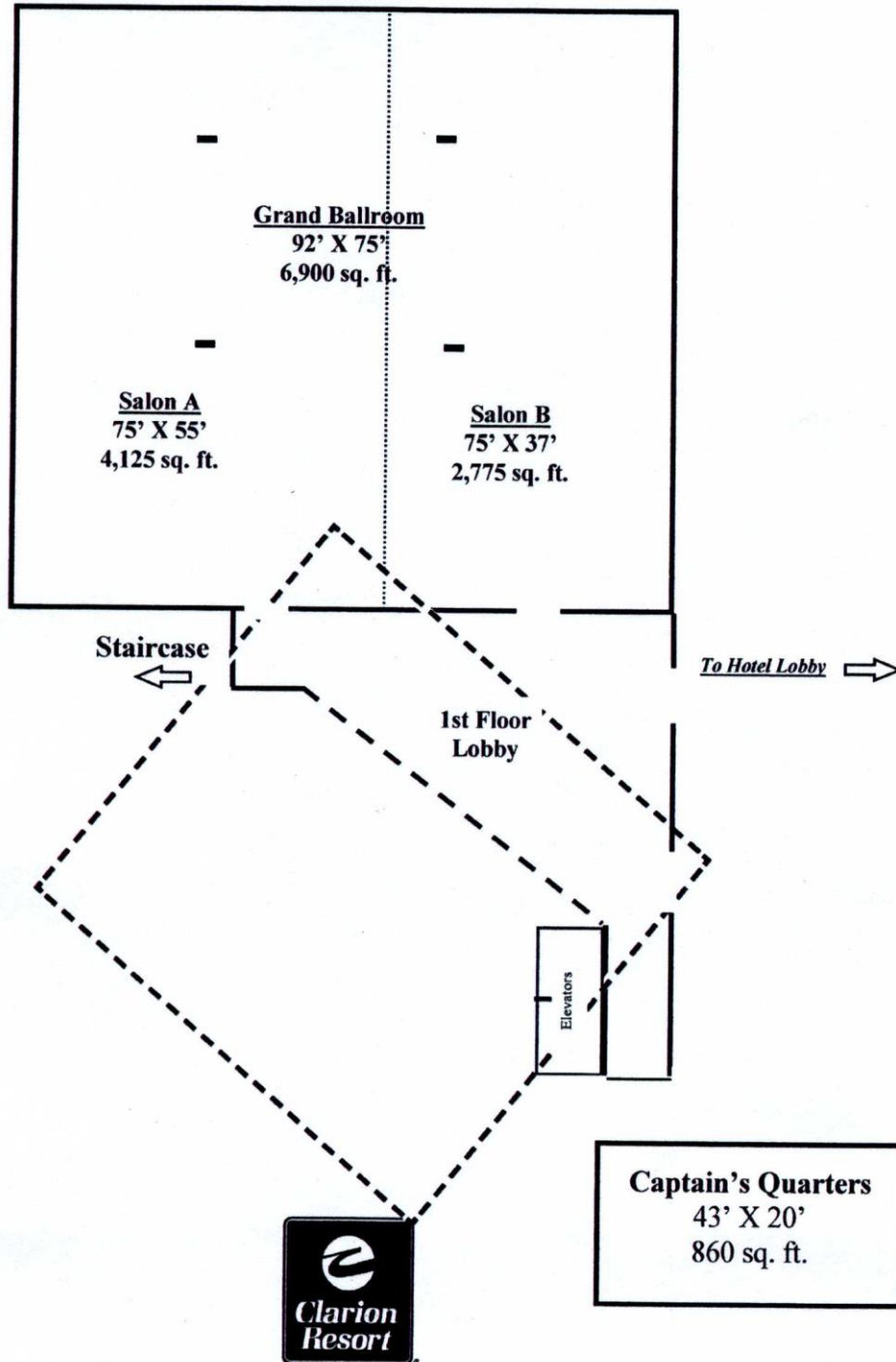

# MEETING & BANQUET FACILITIES

## Second Floor

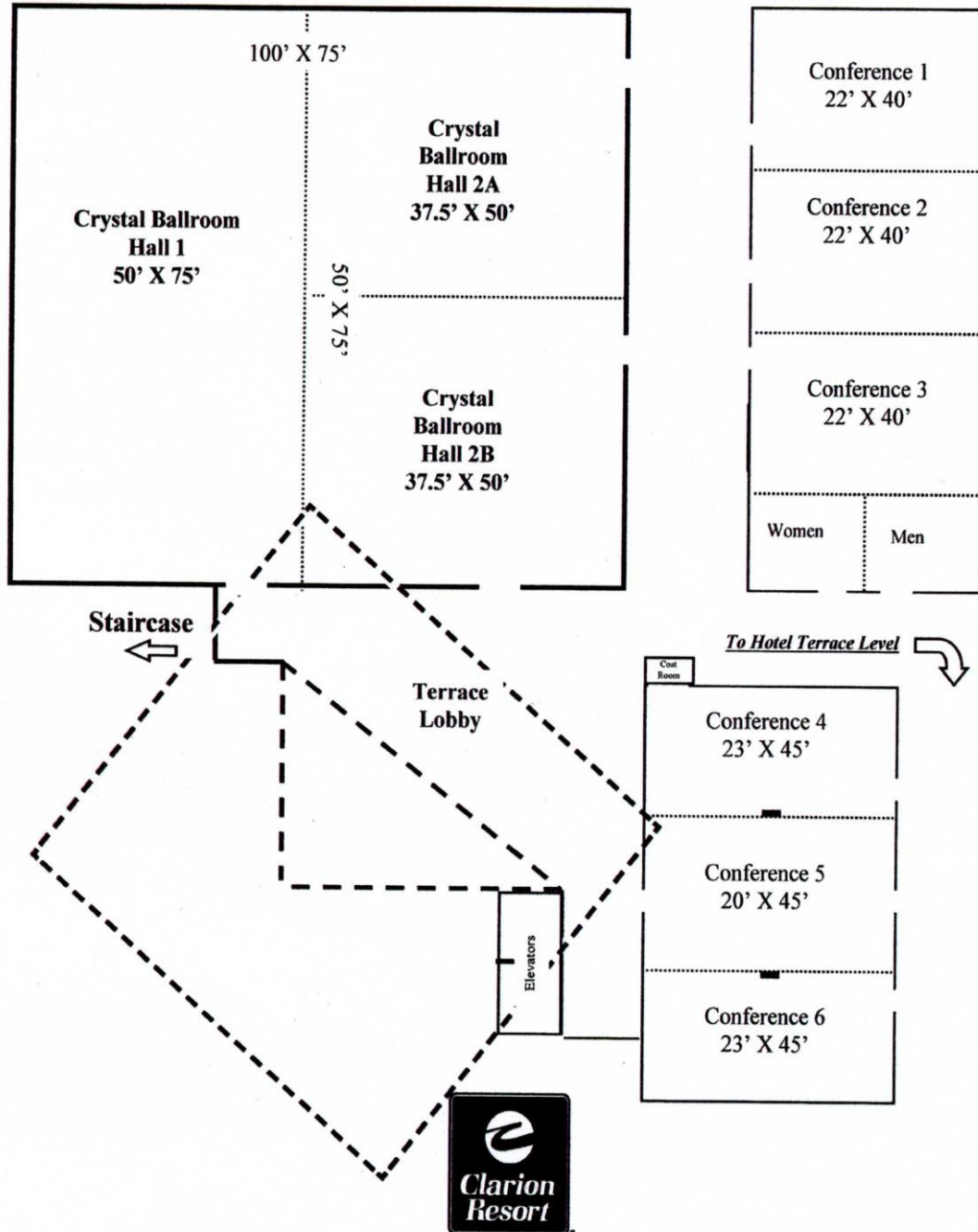

## Participating Vendors and Sponsors

*Please visit our vendors throughout the conference in the Vendor Exhibit Hall – Salon A*

Achievement Network	Alia Peera
Benchmark Education/MathSpace	Tom Lombardo
Capstone	Lauri Taylor
Cengage Learning/ National Geographic Learning	Donn Livingstone
The College Board	Keith Henry
Continental Press	Holly Wilson
Curriculum Associates	Kathy Walsh
Educational Testing Service	Lisa Bauman
EPS Literacy & Intervention	Holly Wilson
GradeCam	Rick Porter
Houghton Mifflin Harcourt – Assessments	Clint Hubbard
Learning Sciences International	Beth Carr
Lexia Learning	Emily Federico
McGraw Hill Education	Heather Mooney
Northwest Evaluation Association	Jim Tilghman
PARCC Inc.	Bonnie Hain
Pearson Assessment	Lisa Lepic and Joy Heitland
Perfection Learning	Maureen Rich
Performance Matters	Marnie Stockman
Perma-Bound Books	Joseph Lenza
Renaissance Learning	Jordan Savit
SchoolCity	Danita Williams
Star Shine Learning	Devin Pintozzi
TC Education-Heinemann and Okapi	Catherine McIntyre
Turnitin	Melissa Perlman